

INSTALLATION GUIDE

SINGLE DOOR

JANUARY 2026 V1



Contents

Introduction

Important Information & Key Features	Page 1
Health & Safety	Page 1

Pre-Installation Work

Pre-installation Checks	Page 2
Preparing the Aperture	Page 3
Pre-Fit Assembly	Page 3

Installation

Preparing the Base	Page 4
Fitting the Cill	Page 5
Positioning the Door	Page 6
Fixing the Frame	Page 7
Fixing the Hinge Jamb	Page 8 & 9
Fixing the Lock Jamb	Page 10 & 11

Hinge Adjustment

SFS Hinge Adjustment	Page 12 & 13
MILA Flag Hinge Adjustment	Page 14

Internal and External Finishing

External Finishing	Page 15
Internal Finishing	Page 16

Handing Over

Monthly Maintenance	Page 17
---------------------	---------

Installation Guide Scope

Welcome to the Endurance Doors Installation Guide – your go-to resource for achieving efficient, high-quality door installations. We've created this comprehensive guide to support our Installer Partners with every step of the installation process, helping to ensure each job is completed right the first time. By following these best practices, you can significantly reduce the likelihood of call-backs, saving valuable time, enhancing customer satisfaction, and protecting the reputation of your business.





Professional Installation & Warranty Requirements

Endurance Doors must always be fitted by an experienced window and door installation professional.

The validity of our comprehensive 10-year product warranty is dependent on the product being installed in full accordance with this guide.

Key Features of This Installation Guide

Throughout this Installation Guide, you'll find a range of clearly defined instructions and guidance designed to support a successful and compliant Endurance Door installation. Please look out for:

 GOLDEN RULES	 INSTALLATION TOLERANCE	 INSTALLATION RECOMENDATION
These are mandatory requirements that must be followed at all times to ensure full compliance with this guide.	These tolerances must be followed in all standard installations. We recognise that site conditions can occasionally make full compliance impossible, but any deviation should only occur where absolutely necessary and must be justified by on-site conditions.	These helpful tips aren't compulsory but are designed to enhance the overall performance, longevity, and quality of the finished installation.

Health & Safety

At Endurance Doors, the wellbeing of our Installer Partners is paramount. Before starting any installation, it's important to evaluate the site and follow all relevant health and safety procedures.

In addition to your own Risk Assessments and Method Statements (RAMS), please ensure the following guidelines are observed:

- ✓ A fully assembled Endurance Door can weigh up to 70kg, so installation must always be carried out by two people.
- ✓ When removing packaging, use a knife carefully, cutting away from your body along the frame's edge - make sure not to scratch any surfaces that will be visible post installation.
- ✓ Always use an RCD (Residual Current Device) with any 240v power tools or equipment.
- ✓ Keep children and pets well away from the work area during installation.
- ✓ Dispose of all waste materials safely and in accordance with local regulations.

Personal Protective Equipment (PPE)

To ensure a safe working environment, appropriate PPE must be worn at all times during installation. The icons to the right highlight the essential protective equipment required for a compliant and safe Endurance Door installation.

Minimum PPE Recommendation:



Safety Shoes/
Boots/Trainers



Safety
glasses



Cut proof
gloves



Hearing
protection

Making the Right First Impression

First impressions matter. Follow these best-practice steps to build trust from the moment you arrive:

- ✓ Ask permission before parking on the homeowner's drive.
- ✓ Introduce yourself, show ID, and invite any questions.
- ✓ Remind the homeowner to keep children and pets away from the work area.



Pre-Installation Checks

Before removing the existing door, it's essential to complete the following pre-installation checks to ensure a smooth and successful installation:

- ✓ **Inspect the structural integrity** of the existing opening to confirm it's suitable for installation.
- ✓ **Check for any damage or missing components** in the new door set and accompanying hardware.
- ✓ **Invite the homeowner to inspect the new door** and confirm they're happy before installation begins.
- ✓ **Verify the size and specifications** of the new door against the order paperwork and the actual aperture.
- ✓ **Ensure the door dimensions allow for adequate** expansion within the aperture, in line with the guidance provided in the table below:

The table below outlines the required deductions from the aperture size when ordering doors in the following configurations.

White Frame		Foiled Frame	
Width	Height	Width	Height
10mm	15mm	15mm	15mm

Completing these checks in advance helps avoid delays, ensures correct fitting and supports a professional finish.

Once all pre-installation checks are complete, place the new door in a safe, stable location where it is protected from wind and cannot fall or be damaged.



GOLDEN RULE

For frames with a 52mm threshold profile and a 72mm jamb profile, **apply silicone sealant inside the visible hole at each end of the threshold** to prevent water ingress.

Preparing the Aperture

Once the existing door has been removed in accordance with your company's policies and procedures, you'll need to:

- ✓ Remove any residual silicone or mastic from the brickwork and clean the surface as thoroughly as is reasonably practical.
- ✓ Brush down the brickwork using a soft-bristle brush to eliminate any remaining dust or debris.
- ✓ Tidy the working area by sweeping up and removing any tools or equipment that are no longer needed.
- ✓ Vacuum the aperture, threshold, and internal working area to ensure a clean and clear environment for installation.



Pre-Fit Assembly

- ✓ **Fit the Locking Cylinder** before installation, making sure it's oriented correctly - the side marked EXT with Anti-snap lines should face externally.
- ✓ **Install lever/lever handles** prior to fitting the door. Pull bars and knobs should be fitted after installation.
- ✓ **Secure any Add-Ons** to the main frame using appropriately sized 4.3mm hardware-to-PVCu screws. A silicone seal should be applied between the add-on and the frame to ensure a secure, weather-resistant connection.

Removal of Door Slab from the Frame

In some instances, it may be preferable to remove the door slab from the frame prior to installation. If so, please follow the instructions below to ensure this is done safely and without causing damage.



- 1 Remove the top, bottom and side hinge caps.
- 2 Loosen the top and bottom grub screws using a 2mm Allen key.
- 3 Remove the hinge pin by inserting a 4mm Allen key into the centre of the hinge and turning to release it.
- 4 Repeat these steps for each hinge and carefully lift the slab away from the frame, ensuring it is supported to prevent damage.



- 1 Open the door fully to remove the hinge cover retaining bolt using a No. 2 Phillips screwdriver.
- 2 Open the hinge cover by inserting a 5mm flathead screwdriver into the recess and gently unclipping the cover.
- 3 Remove the 4 wood screws (5mm x 50mm) that secure the hinge to the slab.
- 4 Repeat these steps for each hinge and carefully lift the slab away from the frame, ensuring it is fully supported to prevent damage.

Preparing the Base



INSTALLATION TOLERANCE

Check that the base is level using a 600mm spirit level.

If necessary, use appropriately sized packers to achieve a level foundation before proceeding with the installation.



GOLDEN RULE

Once the base is level, add a 2mm packer on the hinge side. This helps distribute the weight evenly and ensures the slab doesn't foul the bottom of the frame.



Adhere any packers that have been used to the base and to each other using clear LMN silicone.

This action will ensure they remain securely in place during and after installation.



Apply a generous bead of clear LMN silicone along the base, fully covering the packers.

Extend the seal approximately 100mm up each side where the brickwork meets the internal reveal to ensure a continuous seal.

Fitting the Cill

If the door you are fitting includes a PVC cill, please follow the next set of instructions.
If not, skip ahead to the next page.



Place the PVCu cill onto the base, pressing down firmly to ensure it sits tightly against the packers and forms a strong, continuous seal with the silicone.



Check the level of the cill now that it has been installed and to ensure it remains 2mm higher on the hinge side.



Apply a silicone seal approximately 10mm in diameter across the length of and ends of the PVCu cill to ensure a continuous seal once the door has been lifted into place.

Positioning the Door



1

Lift the door onto the cill and temporarily secure it in position using timber wedges, packers, or an air bag. Ensure that the silicone seal between the bottom of the door and cill is unbroken.

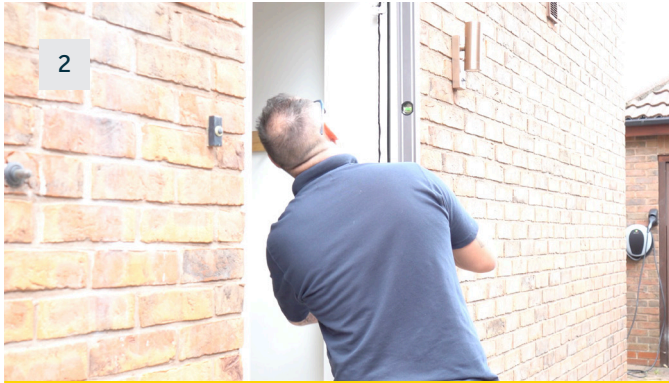

2

 **GOLDEN RULE**

You must check that the hinge side is plumb using a 1.8m spirit level. You may need to cut back or pack between the frame and plaster line to achieve proper alignment.



3

Once the hinge side is plumb, check that the frame is square by placing a 1.8m spirit level against the rebate on the hinge side frame.



4

Pack all four corners between the frame and the brickwork to ensure the frame stays square and does not bend when fixing it to the brickwork.



5

If you are installing onto a cill, drill three 4mm pilot holes through the threshold to fix the frame to the cill: one 70–90 mm from each corner and one in the centre. If the door you are installing has an aluminium threshold, take care not to drill through the thermal break.

Countersink each pilot hole to allow the screw heads to sit flush, ensuring a neat finish for improved aesthetics.

Fix the threshold to the cill using the following screws:

Threshold Type:	Screw Specification:
52mm PVCu	5mm x 50mm multipurpose wood screws
72mm PVCu	5mm x 70mm multipurpose wood screws
Low Aluminium	4.3mm x 30mm Hardware to PVCu screws

Fixing the Frame

Now the door is temporarily held in position, and you have checked the hinge side for plumb and square; you can now move on to fixing the frame.

Fixing Positions

Please follow the instructions below for fixing locations and the correct order of installation.

Before proceeding to fix the door in place, make sure you read the information on the following pages.

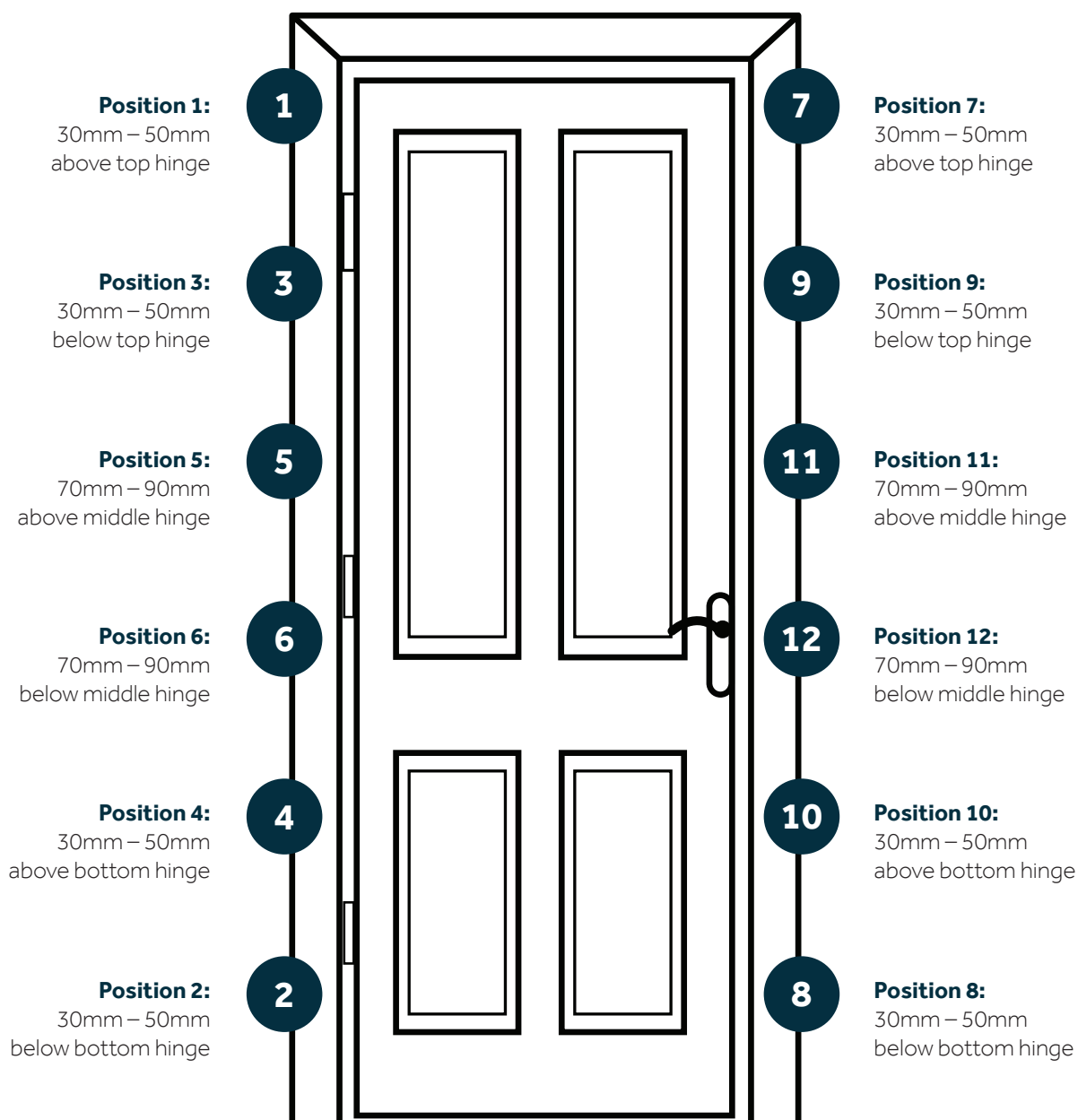

The above fixing positions apply for doors with 3 hinges and a Guardian5, AV2 or AV4 locking mechanism.
Doors with 4 hinges: Spread the hinge jamb fixings evenly to ensure each hinge is properly supported.
Doors with Quadhook+ locking mechanisms: Spread the lock jamb fixings evenly between the hooks

Fixing the Hinge Jamb



GOLDEN RULE

Fixings must penetrate the brickwork by at least 50mm into solid masonry - not into the mortar joint. This ensures a secure hold and prevents the frame from loosening over time.



INSTALLATION RECOMMENDATION

For the installation of Endurance Doors, we recommend using:

**RapierStar StarFix - 7.5 mm × 112 mm
PFT dome head direct masonry fixings**

1



Drill a 6mm pilot hole into the PVCu frame in Position 1 on the 'Fixing Positions' diagram. Drilling pilot holes helps prevent the frame from cracking, especially in colder conditions.

2



Use an SDS drill with a 6.5mm SDS masonry drill bit to drill into the pilot hole you have just created, ensuring you are penetrating at least 50mm into solid masonry, not into the mortar joint.

3



Pack between the frame and brickwork to ensure the frame is not distorted while fixing.
Fix Position 1.

4



Repeat these steps to fix Position 2.

If the frame has an aluminium threshold, the bottom corners must be packed tightly against the brickwork to prevent the frame from spreading at the bottom when the fixings are tightened.



5

Place a 1.8 m spirit level on the external face of the frame to check that there is no bow in the jamb. Pack between the reveal and the frame as needed to keep the frame straight.



6

Once you have confirmed the hinge jamb is straight, proceed with fixing Positions 3 & 4. Ensure you pack between the frame and brickwork at each fixing location.



7

Proceed with fixing Positions 5 & 6, again making sure to pack between the frame and brickwork at each fixing location.



8

Once the hinge jamb is fixed in position, place a 1.8 m spirit level against the frame rebate (as if checking for square) to ensure there is no lateral bow caused by overtightening. If a bow is present, adjust the fixings to get the jamb straight.



GOLDEN RULE

If you chose to remove the slab from the frame prior to fitting, refit the slab before moving to fixing the lock side.

Place a 5mm packer on the threshold to bear the weight of the slab prior to lifting the slab back into the frame.

Fixing the Lock Jamb



GOLDEN RULE

Close the door and check by eye that the door slab and the internal edge of the lock jamb are in alignment.

If the door slab does not line through with the internal edge of the frame, pack between the reveal and the frame as required until the slab and frame line through.



Once the slab and internal edge of the frame are in alignment, proceed with fixing Positions 7 & 8.

Always make sure to drill pilot holes in the frame and pack between the frame and brickwork around each fixing.



INSTALLATION RECOMMENDATION

If the door you are fitting opens inwards, place a 2mm – 3mm packer between the reveal and frame near the centre latch before proceeding to fix the remaining fixing points. This adjustment will draw the top and bottom of the door slab more firmly into the frame, ensuring the slab does not stand off the frame on the inside.



Proceed with fixing the remaining positions 9 to 12.



Once the frame is fully fixed into the aperture, take a few minutes to double-check each jamb and the installation is compliant with the instructions set out in the proceeding steps.



Deflecting the Centre of the Lock Jamb – Why?

Slightly deflecting (bowing out) the centre of the lock jamb ensures the door seals properly when closed. This creates consistent compression on the weather seals, improving security and preventing draughts or water ingress. Once the lock engages, the jamb will pull back slightly into line, providing a tight, reliable fit.



Hinge Adjustment

Post installation hinge adjustments are vital to the correct operation of the door and to prevent common callbacks.

SFS Hinge Adjustment

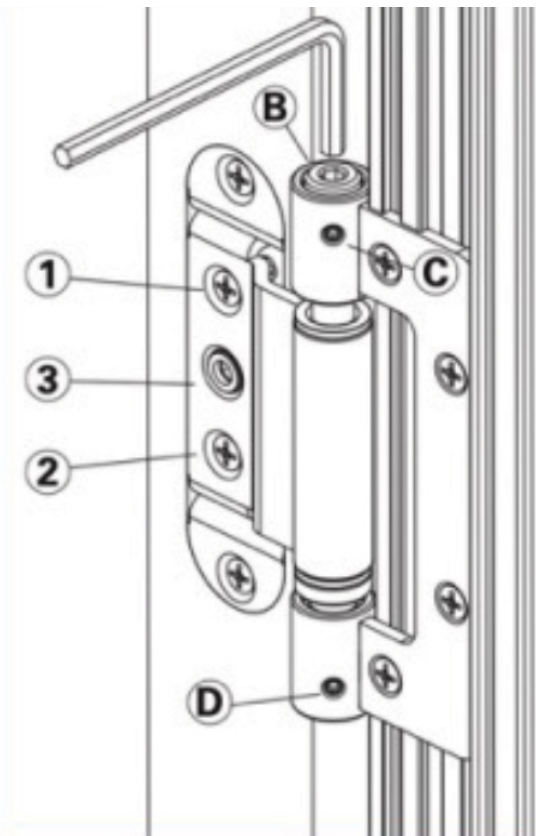

INSTALLATION TOLERANCE

When using SFS hinges, the internal gap between the slab and the frame should be consistent and parallel. It must measure between 3–4 mm on the hinge jamb and between 4–5 mm on the lock jamb and the head of the door.

Type of Adjustment	Available Adjustment
Horizontal	± 2mm
Vertical	-2/+6mm

SFS Hinge Adjustment



GOLDEN RULE

You must always ensure that grub screws C & D are tightened before leaving site, even if no hinge adjustments are made. Failure to complete this step will likely result in the door dropping and an unnecessary call back.

Horizontal Adjustment:



Due to the way SFS butt hinges are fitted into the slab, the lateral adjustment and margins are not set in the factory and must be set during installation.

To adjust, open the door fully to access the hinge adjustment.



Loosen screws 1 & 2 by three turns. Tighten or loosen screw 3 with a 4mm Allen key to achieve the required adjustment.

Once adjusted, always make sure to retighten screws 1 & 2 before leaving site

Vertical Adjustment:

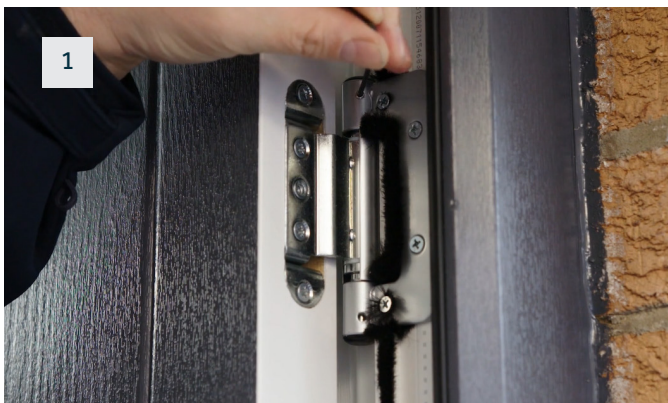

The vertical adjustment is factory-set and should not require changes.

However, if the slab was removed before frame installation, you can adjust the hinge pin to maintain a 4mm - 5 mm gap at the head of the door and ensure all three hinges share the load evenly.

To adjust, open the door fully to access the hinge adjustments and loosen the grub screws labelled C & D.

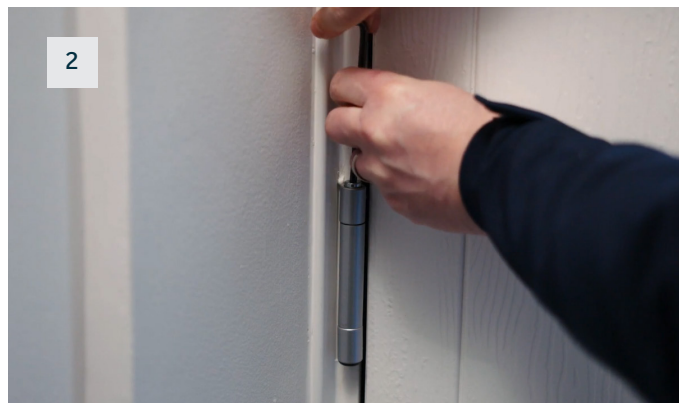

Remove the top hinge cover cap.

Turn the pin labelled B with a 4mm Allen key, tightening or loosening to achieve the desired adjustment.

Once adjusted, always make sure to reinsert the hinge cover cap and retighten the grub screws labelled C & D, as per the Golden Rule at the top of this page.

MILA Flag Hinge Adjustment

Due to the way MILA Flag hinges are fitted during factory assembly, the margins and height are pre-set. However, some fine-tuning of the lateral adjustment may still be required on site.



GOLDEN RULE

Always open the hinge cover and tighten the lock-off bolts, even if no adjustments are made. Failure to do so may cause hinge movement under the slab's weight, leading to a call-back.



INSTALLATION TOLERANCE

When using MILA flag hinges, the internal gap between the slab and the frame should be consistent and parallel. It must measure between 4–5 mm on each jamb and the head of the door.

Horizontal Adjustment:



Remove the hinge cover retaining bolt using a No. 2 Phillips head driver. Then insert a 5mm flathead screwdriver under the cover cap and twist to pop the cover off.



Once the cover is removed, use a 4mm Allen key to turn the unlock screw a ¼ turn. Then, use the adjustment screw to adjust 5mm in either direction. When adjustment is complete, retighten the unlock screw, replace the hinge cover and fit the security screw back in. Repeat this process for all hinges.

Vertical Adjustment:



To access the vertical and compression adjustment, use a 5mm flathead screwdriver to pop off the top and bottom hinge cover caps. For vertical adjustment, use a 4mm Allen key to turn the back screw down and lift the hinge by up to 5mm.

Compression Adjustment:



For compression adjustment, push the front hinge pin out and use a 4mm Allen key to adjust the compression. Once the adjustment is complete, push the hinge pin back in and replace the top and bottom hinge cover caps. Repeat this process for all hinges.

External Finishing

Now you have completed the fixing of the installation, it is now time to move on to finishing the external side of the door.



GOLDEN RULE

Before proceeding with the external finishing of the door, clean down the frame and door using soapy water or non-solvent wipes and ensure the working area is swept and clean.



INSTALLATION RECOMMENDATION

To deliver a professional, seamless finish, we recommend using perfectly colour-matched finishing trims, available through the Endurance Door Designer.

Using Finishing Trims



If you are using finishing trims, measure and cut the required lengths and secure to the installation using silicone.

Then, use silicone to seal the gap between the finishing trims and the door.

Ensure that any silicone that has spilled onto the frame is quickly wiped away using a non-solvent wipe.

Using Silicone Only



Use masking tape to create a 5mm border around the perimeter of the installation.

Ensure the lines are straight and even.

Cut the nozzle on your silicone to suit and apply around the edges of the frame.

Use your finger or a smoothing tool to smooth down the silicone.

Once complete, remove the masking tape immediately, before the silicone has time to cure.

Internal Finishing

The final job to complete before handing over to the homeowner is the internal finishing.



GOLDEN RULE

Before proceeding with the internal finishing of the door, clean down the frame and door using soapy water or non-solvent wipes and ensure the working area is swept and clean.

Using Finishing Trims



If you are using finishing trims, measure and cut the required lengths and secure to the installation using silicone.

Then, use silicone to seal the gap between the finishing trims and the door.

Ensure that any silicone that has spilled onto the frame is quickly wiped away using a non-solvent wipe.

Replace the silicone in your gun with acrylic and use this to seal the gap between the door frame or finishing trims and the plaster line.

Using Acrylic Only



Replace the silicone in your gun with acrylic and use this to seal the gap between the door frame and the plaster line.

Ensure that any acrylic that has spilled onto the frame or plaster is quickly wiped away using a non-solvent wipe.

Use your finger or a smoothing tool to smooth down the acrylic for a neat finish.,

Handing Over

Once you have completed the installation, it is now time to hand over to the homeowner.



Allow the homeowner an opportunity to review the installation, ensuring they are happy with the product and the work that has been carried out.

It is always good practice to demonstrate the operation of the door, ensuring the homeowner is clear on how to lock and unlock their new Endurance Door.



Hand over the Endurance Doors essential maintenance hanger, making sure to talk through the operation, maintenance and cleaning guidance included.

Provide any other paperwork as per your company's policies and explain to the homeowner your company's policy for requesting aftersales support.

Explain to the homeowner the below guidance and following essential maintenance that is required to keep their new door looking great and operating flawlessly for years to come.

Installer Guidance: Key Points to Share with the Homeowner

- ✓ Inform the homeowner that their door is constructed from environmentally friendly natural timber, which may experience slight movement at the top and bottom as it adjusts to its new environment.
- ✓ Advise them to turn off any radiators or direct heat sources located near the door for the first eight weeks after installation. Keeping the area cool and consistent in temperature will help prevent excessive movement during this settling period.
- ✓ Instruct the homeowner to always fully engage the locking points by lifting the handle or turning the key each time the door is closed. This is essential to stabilise the door and reduce the impact of temperature variations on the timber.
- ✓ Inform the homeowner not to use anything other than mild soapy water for cleaning the door and hardware.
- ✓ Explain to the homeowner the importance of lubricating the locking cylinder, locking mechanism and hinges every 6 months using ABS Lock Lube.

Please note: If door maintenance is not carried out in accordance with the above guidance, it may affect the warranty offered to you, our trade customer.

Your installation is now complete.

-  01652 659 259
-  support.technical@endurancedoors.co.uk
-  endurancedoors.co.uk
-  Endurance Doors, Atherton Way,
Brigg, North Lincolnshire DN20 8AR

